

1. Tap the timer button to turn on the timing function.
2. Select the timing time 15 minutes / 30 minutes / 45 points / 60 points
3. Press the timer button continuously to turn off the timing function.

Infinitely intelligent touch regulation

Poleless Intelligent Gradient Temperature/Brightness Memory Regulation

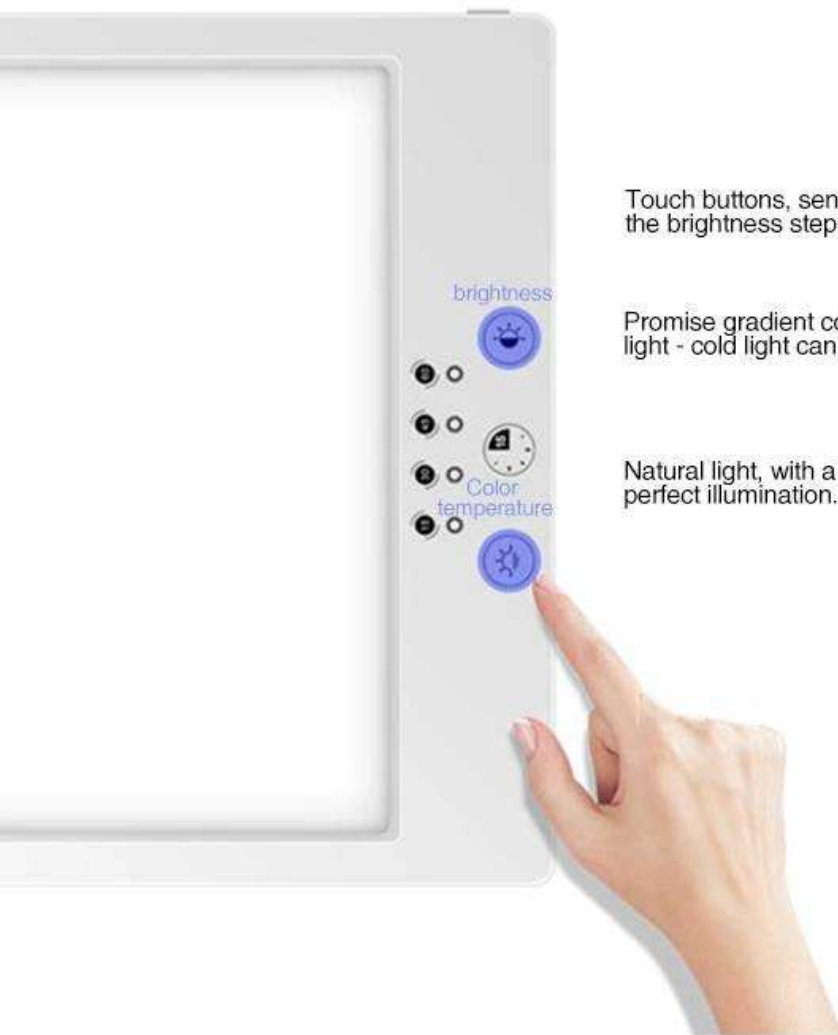

Touch buttons, sensitive controls, you can easily operate. Long presses adjust the brightness steplessly to meet your needs in different situations.

Promise gradient color temperature, long press color temperature button, warm light - cold light can be changed at will, let you feel relaxed and comfortable.

Natural light, with a natural light of 12,000 lux, mimics the sun and gives you the perfect illumination.

Stepless dimming smart touch adjustment

Stepless dimming gradient color temperature
Brightness memory adjustment

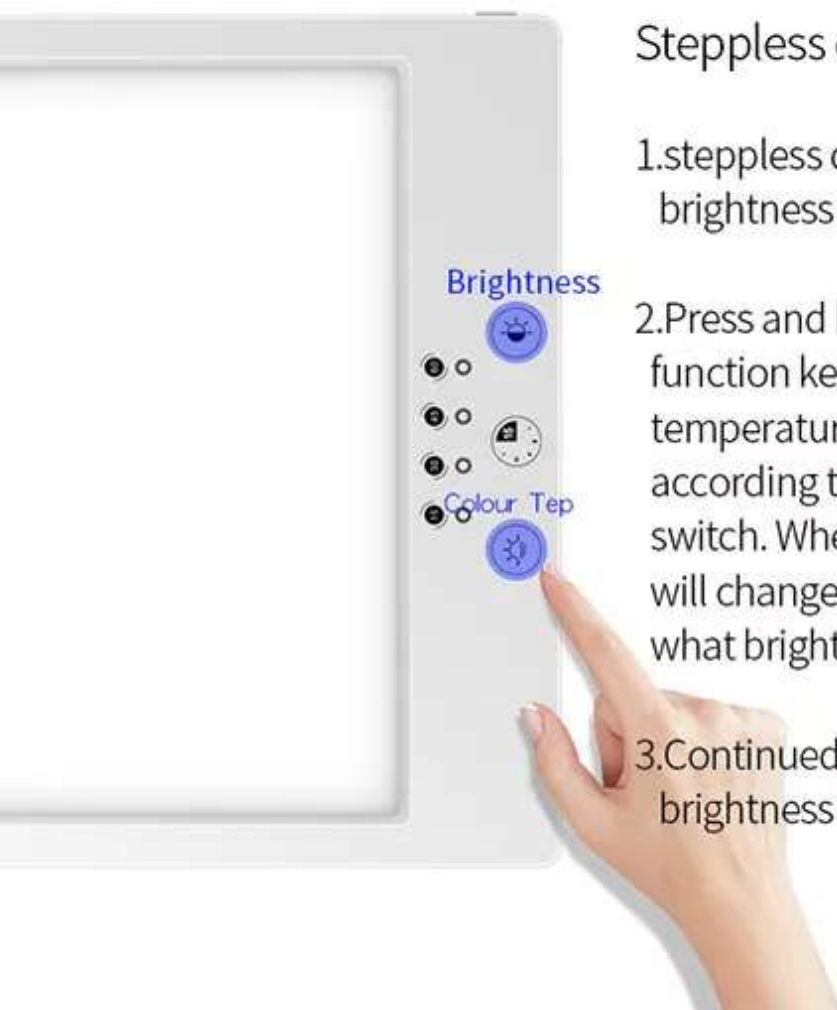

Stepless dimming touch:

1. stepless dimming is 0-100% color temperature / brightness free gradient.
2. Press and hold the color temperature/brightness function key to determine the percentage of color temperature/brightness of the phototherapy lamp according to the length of time you press the touch switch. When you press and hold the switch, the light will change in time. You can use the naked eye to feel what brightness is most suitable for the loose.
3. Continued use after power off will memorize the brightness used last time.